

TRUEFIRE™ HIGH ENERGY PILOT

The Quality You Need, the Performance You Expect

As a global leader in developing state-of-the-art combustion technologies and environmental solutions, John Zink understands your single pilot and ignition needs. Our TruFire electric ignition pilots are designed to provide safe and reliable performance for thermal oxidizer and burner operation.

Extensive field experience and thorough testing at John Zink's Research, Development and Test Center proved our TruFire pilots operate in the most severe combustion applications — even under water.

TruFire Pilot Features

- Uses compressed air to provide 100% premixed fuel for improved stability in high-draft and pressurized applications
- Safely retractable and removable from the burner even during burner operation (manual and pneumatic retraction)
- Robust, stable flame ensures burner ignition and flame detection
- Stainless steel construction to minimize corrosion and maximize service temperature

High Energy Ignition Features

- Powerful capacitance discharge spark provides more reliable ignition than a conventional spark plug igniter
- High Energy probe is not affected by moisture and will spark even when completely immersed in water
- A fixed / non-adjustable spark gap ensures proper installation and reliable spark

UltraFlex High-Heat Release Option

- Wide range of heat release for unit startup and refractory dry out applications
- Sightport / scanner option for an all-in-one design with ignition and flame confirmation

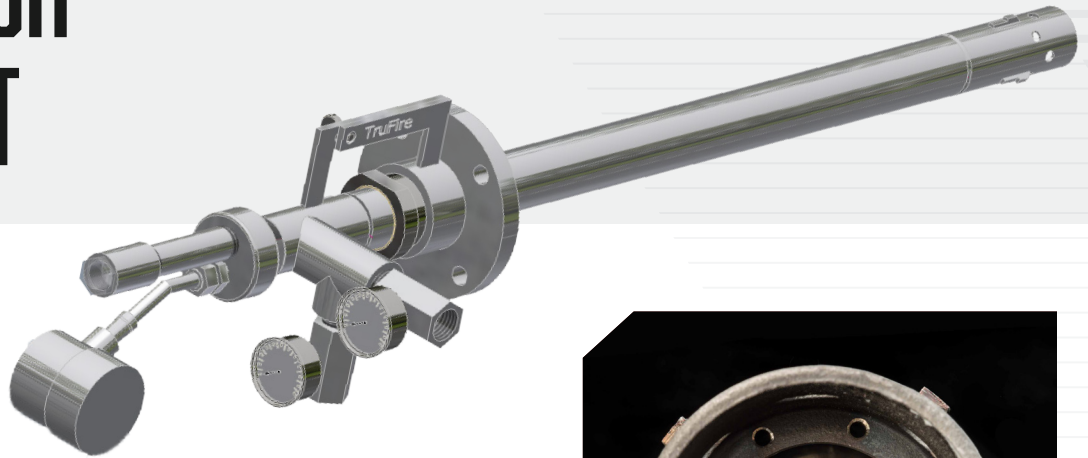

TRUFIRE™

Proven in 100+ Installations

TruFire electric ignition pilots have been proven in more than 100 installations, including rigorous testing at the John Zink Development and Test Center, the largest and most advanced testing complex of its kind.

For more information, visit johnzink.com.

Specifications and Options

Pilot Type	Min. Guide Pipe Size, Sch 80 or 40	Heat Release Btu / hr	Compressed Air Required, SCFM at 10 psig	Retractable with Isolation Valve ¹	Scanner Option ²	Sight Port Option ³
TruFire 1	1-1/2"	40,000 – 50,000	8	Yes	No	No
TruFire 1.5	2"	100,000 – 200,000	35	Yes	No	No
TruFire 2	3"	200,000 – 500,000	70	Yes	Yes	Yes
TruFire UltraFlex	3"	200,000 – 13,500,000	70 ⁴	Yes	Yes	Yes

¹ Manual retraction is standard, pneumatic retraction is also available. Isolation valve must be installed to safely remove pilot during pressurized burner operation.

² Flame ionization rod is available for all models.

³ Sight port must be removed to install a scanner or a flame ionization rod.

⁴ Not 100% premix.

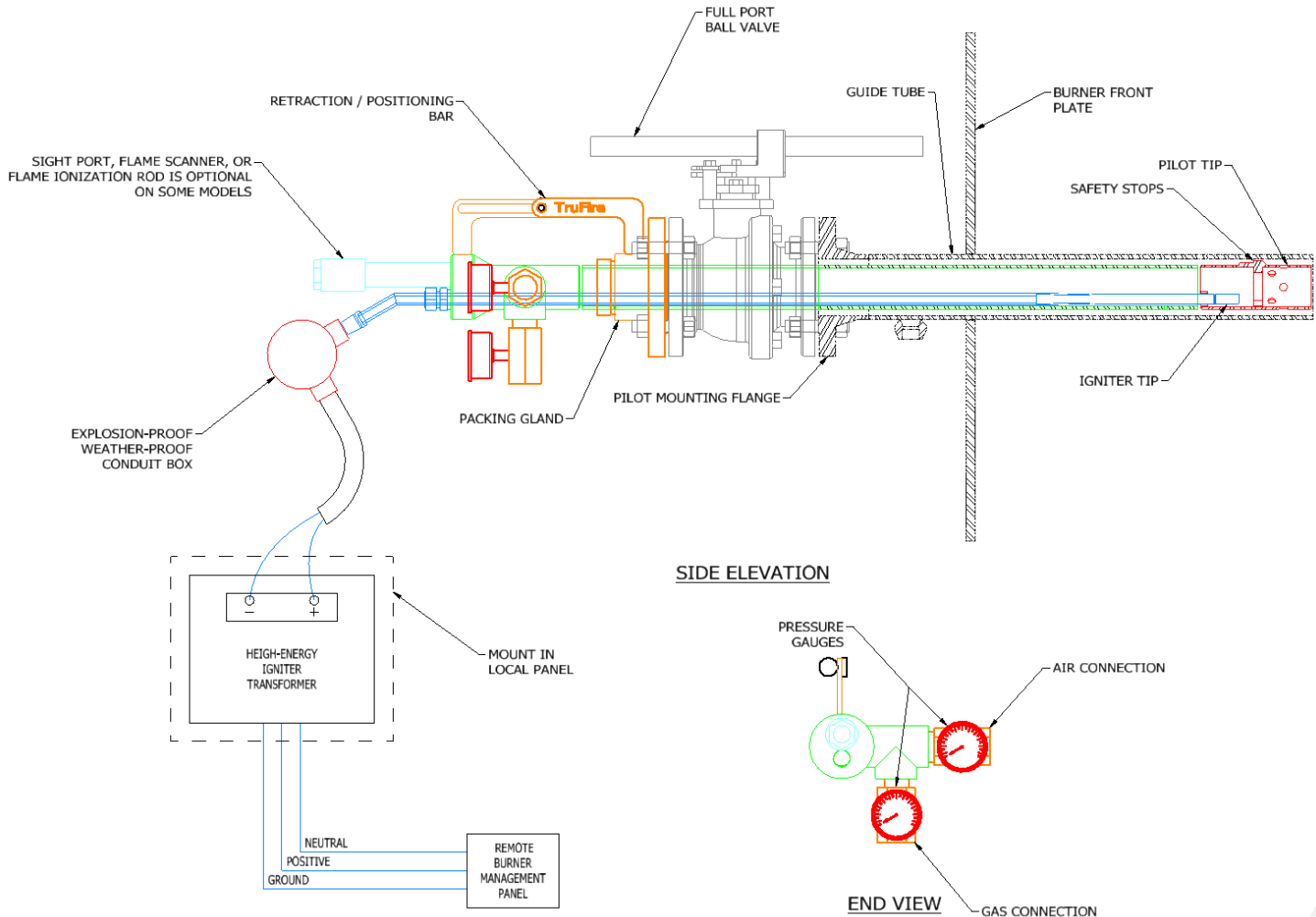

ELECTRICAL SPECIFICATIONS

Input voltage options:

120 VAC / 50-60 HZ / Single Phase
240 VAC / 50-60 HZ / Single Phase
24 VDC

Amperage requirement:

0.35 AMPS - AC
2 AMPS - DC

Spark rate:

2 sparks per second

For more information about the TruFire High Energy pilot, contact info@johnzink.com.

Global Headquarters // Tulsa, OK, USA // +1-918-234-1800 // To locate an office in your region, visit johnzink.com/contact.